



**IMPORTANT NOTE:** See page 2 for important information on how to use this Replacement Parts List.

# TOAST-MAX<sup>®</sup>

## Electric Conveyor Toasters

### *TM Series*

TM-5

TM-10

TM-5H

TM-10H

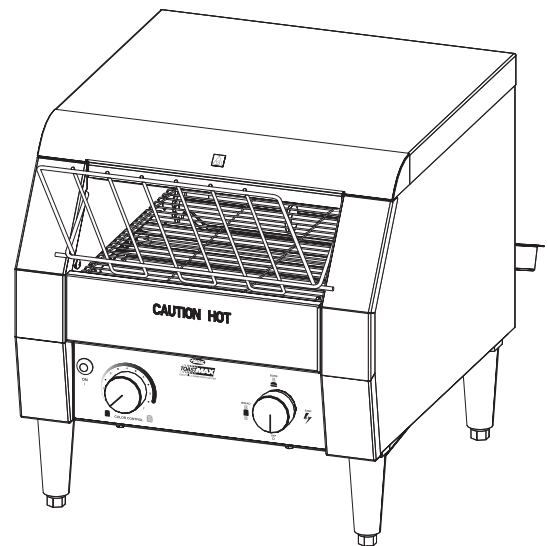
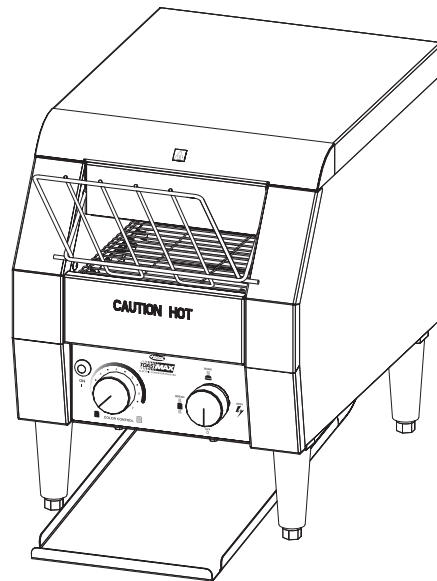

# Replacement Parts List

# HATCO TOAST-MAX CONVEYOR TOASTERS

## TM Series

**Model Designation**

**T M - X H**

Toast-Max ——— | High Opening

                          | 5 = One Slice Width

                          | 10 = Two Slice Width

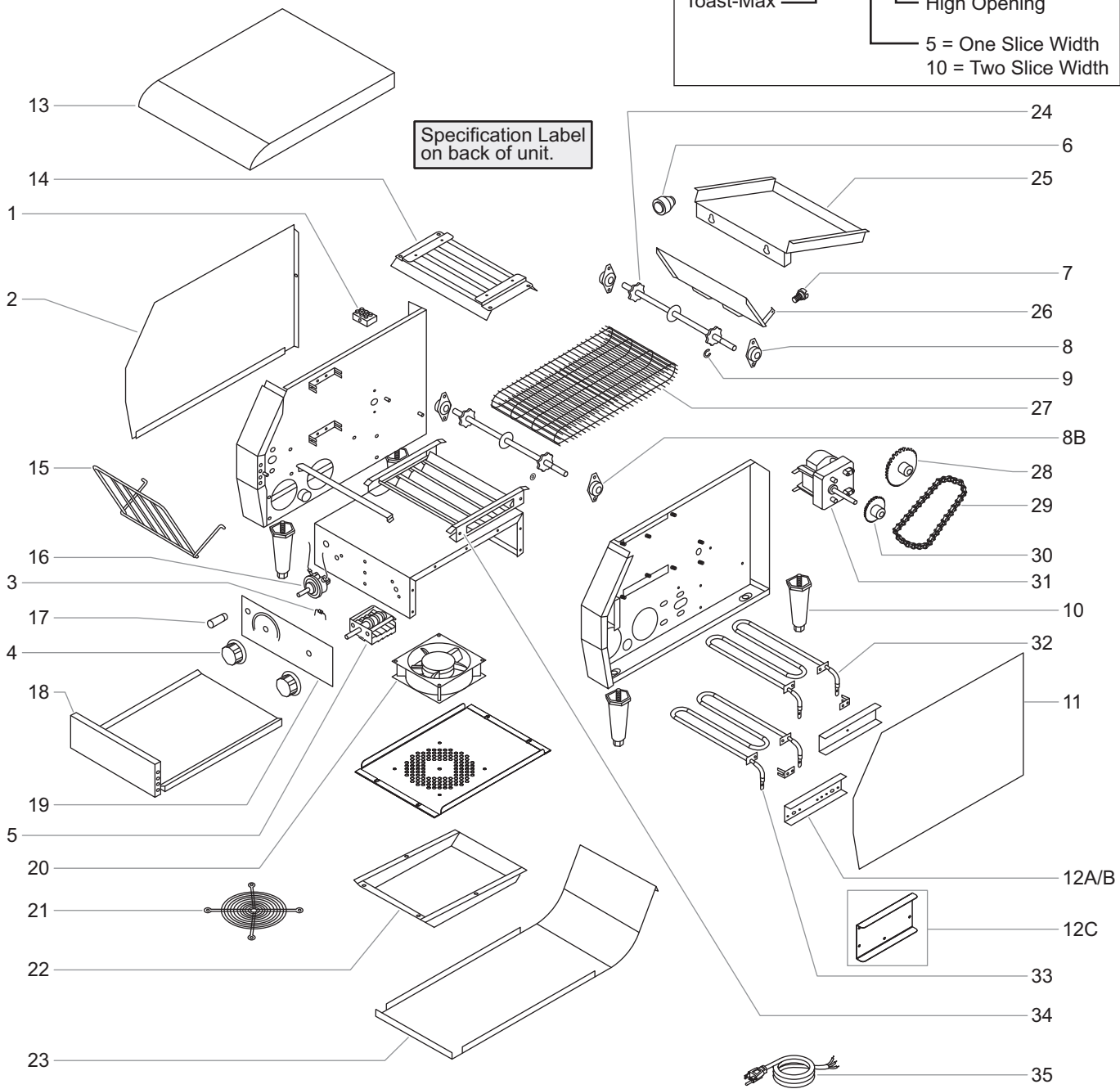

### IMPORTANT! — HOW TO USE THIS REPLACEMENT PARTS LIST

This Replacement Parts List represents toasters built before and after manufacturing and part number changes. Toasters with a manufacturing date code of 0830 and older use **Item** numbers with the "A" suffix. Toasters with a manufacturing date code between 0831 and 1135 use **Item** numbers with the "B" suffix. Toasters with a manufacturing date code of 1136 and newer use **Item** numbers with the "C" suffix. **Item** numbers that are not broken down with "A", "B", or "C" suffixes are the same for all manufacturing date codes.

*NOTE: The last four digits in a ten digit numerical serial number are the manufacturing date code.*

*Example: Serial number 9625060833 has a date code of "0833" which indicates the following: 0833*

Year 2008 ——— |

Week Thirty-Three ——— |



**Use of replacement parts other than those supplied by Hatco Corporation may result in damage to the unit or injury to personnel and will void all warranties.**



## PARTS COMMON TO ALL TM SERIES MODELS

Item	Description	Part No.	Qty.
1A	Terminal Block — 3 Pole	X02.15.052.00	1
1B/C	Terminal Block — 3 Pole	02.15.050.00	1
2A	Side Panel (LH)	X04.05.436.00	1
2B/C	Side Panel (LH)	04.05.564.00	1
3A	Diode	X02.40.046.00	1
3B/C	None (included with item 17B)	---	
4A	Control Knob	X05.30.093.00	2
4B/C	Control Knob	05.30.020.00	2
5	Selector Switch	02.19.174.00	1
6	Cord Grip	02.20.259.00	1

Item	Description	Part No.	Qty.
7A	Thumbscrew	X05.04.488.00	2
7B/C	Thumbscrew	05.04.371.00	2
8A	Bearing Assembly, Front and Rear	X05.02.024.00	4
8B/C	Bearing Assembly, Rear	04.05.286.00	2
	Bearing Assembly, Front	04.05.387.00	2
9	Retaining Ring	05.11.035.00	1
10	Leg, 10 cm (4")	05.30.007.00	6
11A	Side Panel (RH)	X04.05.437.00	1
11B/C	Side Panel (RH)	04.05.563.00	1

## PARTS SPECIFIC TO MODEL TM-5

Item	Description	100 V	120 V	220–240 V (CE)
		50 Hz	60 Hz	50 Hz
12A	Bracket, Element (Qty. 2)	---	---	---
12B	Bracket, Element	---	---	04.05.575.00
12C	Bracket, Element, Top ‡	---	---	04.05.747.00
13A	Top Cover w/Insulation	---	---	---
13B/C	Top Cover w/Insulation	---	---	R04.05.562.00
14	Reflector, Upper Element	---	---	04.05.612.00
15	Wire Feed Ramp	---	---	04.05.611.00
16A	Speed Control, Rheostat	---	---	---
16B/C	Speed Control, Rheostat and Diode Assembly	---	---	02.13.338.00
17A	Indicator Light, Green	---	---	---
	Indicator Light, Red (not shown)	---	---	---
17B/C	Indicator Light, Green	---	---	02.19.150.00
	Indicator Light, Red (not shown)	---	---	---
18	Crumb Tray	---	---	R04.05.580.00
19A	Decal, Control	---	---	---
19B/C	Decal, Control	---	---	07.01.323.00
20A	Fan, Circulating	---	---	---
20B/C	Fan, Circulating	---	---	02.12.039.00
21A	Fan Guard	---	---	---
21B/C	Fan Guard	---	---	---
22	Cover, Cooling Fan	---	---	---
23	Discharge Chute	---	---	04.05.583.00
24	Shaft Assembly (Qty. 2)	---	---	04.05.610.00
25A	Rear Discharge Tray	---	---	---
25B/C	Rear Discharge Tray	---	---	04.05.584.00
26A	Discharge Vane	---	---	---
26B/C	Discharge Vane	---	---	04.05.582.00
27	Wire Belt	---	---	05.03.057.00
28	Sprocket, Conveyor	---	---	05.09.055.00
29	Drive Chain	---	---	05.03.049.00
30	Sprocket, Motor *	---	---	05.09.056.00
31	Gear Motor	---	---	02.12.096.00
32	Heating Element, Upper/Lower, 744 W (Qty. 2)	---	---	02.05.760.00
33	Heating Element, Lower, 600 W	---	---	---
34A	Reflector, Lower Element	---	---	---
34B/C	Reflector, Lower Element	---	---	---
35	Power Cord—NEMA 5-15 Plug	---	---	---
	Power Cord—No Plug	---	---	02.18.038.00
	Power Cord—BS 1363 Plug *	---	---	02.18.068.00
	Power Cord—Schuko Plug	---	---	02.18.038.00
	Wiring Diagram	---	---	10-01-356

‡ Toasters with a manufacturing date code of 1136 and newer ("C" numbers) use one of Item 12B for the bottom element along with one of Item 12C for the top element.

\* Units equipped with the BS 1363 plug set use Motor Sprocket P/N 05.09.057.00 (14 tooth).

## PARTS SPECIFIC TO MODEL TM-5H

Item	Description	100 V 50 Hz	120 V 60 Hz	220–240 V (CE) 50 Hz
12A	Bracket, Element (Qty. 2)	X04.05.449.00	X04.05.449.00	X04.05.449.00
12B	Bracket, Element (Qty. 2)	04.05.575.00	04.05.575.00	04.05.575.00
12C	Bracket, Element, Top ‡	04.05.750.00	04.05.750.00	04.05.750.00
13A	Top Cover w/Insulation	X04.05.435.00	X04.05.435.00	X04.05.435.00
13B/C	Top Cover w/Insulation	R04.05.562.00	R04.05.562.00	R04.05.562.00
14	Reflector, Upper Element	04.05.612.00	04.05.612.00	04.05.612.00
15	Wire Feed Ramp	04.05.611.00	04.05.611.00	04.05.611.00
16A	Speed Control, Rheostat	X02.13.331.00	---	X02.13.330.00
16B/C	Speed Control, Rheostat and Diode Assembly	02.13.339.00	---	02.13.338.00
17A	Indicator Light, Green	X02.19.185.00	---	X02.19.175.00
	Indicator Light, Red (not shown)	X02.19.184.00	X02.19.184.00	X02.19.176.00
17B/C	Indicator Light, Green	---	---	02.19.150.00
	Indicator Light, Red (not shown)	02.19.154.00	02.19.154.00	---
18	Crumb Tray	R04.05.580.00	R04.05.580.00	R04.05.580.00
19A	Decal, Control	X07.03.465.00	X07.03.465.00	X07.03.465.00
19B/C	Decal, Control	07.01.323.00	07.01.323.00	07.01.323.00
20A	Fan, Circulating	X02.12.085.00	X02.12.085.00	X02.12.082.00
20B/C	Fan, Circulating	02.12.030.00	02.12.030.00	02.12.039.00
21A	Fan Guard	X02.12.084.00	X02.12.084.00	X02.12.084.00
21B/C	Fan Guard	---	---	---
22	Cover, Cooling Fan	---	---	---
23	Discharge Chute	04.05.583.00	04.05.583.00	04.05.583.00
24	Shaft Assembly (Qty. 2)	04.05.610.00	04.05.610.00	04.05.610.00
25A	Rear Discharge Tray	X04.05.439.00	X04.05.439.00	X04.05.439.00
25B/C	Rear Discharge Tray	04.05.584.00	04.05.584.00	04.05.584.00
26A	Discharge Vane	X04.05.440.00	X04.05.440.00	X04.05.440.00
26B/C	Discharge Vane	04.05.582.00	04.05.582.00	04.05.582.00
27	Wire Belt	05.03.057.00	05.03.057.00	05.03.057.00
28	Sprocket, Conveyor	05.09.055.00	05.09.055.00	05.09.055.00
29	Drive Chain †	05.03.049.00	05.03.049.00	05.03.049.00
30	Sprocket, Motor *	05.09.056.00	05.09.056.00	05.09.056.00
31	Gear Motor	02.12.081.00	02.12.081.00	02.12.096.00
32	Heating Element, Upper, 700 W	02.05.677.00	02.05.678.00	02.05.679.00
33	Heating Element, Lower, 600 W	02.05.680.00	02.05.681.00	02.05.682.00
34A	Reflector, Lower Element	X04.05.526.00	X04.05.526.00	X04.05.526.00
34B/C	Reflector, Lower Element	---	---	---
35	Power Cord—NEMA 5-15 Plug	R02.18.154.00	R02.18.154.00	---
	Power Cord—No Plug	---	---	02.18.038.00
	Power Cord—BS 1363 Plug*	---	---	02.18.068.00
	Power Cord—Schuko Plug	---	---	02.18.038.00
	Wiring Diagram	10-01-356	10-01-356	10-01-356

‡ Toasters with a manufacturing date code of 1136 and newer ("C" numbers) use only one of Item 12B for the bottom element along with one of Item 12C for the top element.

† Drive Chain P/N 05.03.040.00 is used on TM-5H models manufactured before year 2005, week thirty-eight.

\* Units equipped with the BS 1363 plug set use Motor Sprocket P/N 05.09.057.00 (14 tooth).

**PARTS SPECIFIC TO MODEL TM-10**

Item	Description	100 V 50 Hz	120 V 60 Hz	220–240 V (CE) 50 Hz
12A	Bracket, Element (Qty. 2)	---	---	---
12B	Bracket, Element	---	---	04.05.575.00
12C	Bracket, Element, Top ‡	---	---	04.05.747.00
13A	Top Cover w/Insulation	---	---	---
13B/C	Top Cover w/Insulation	---	---	R04.05.619.00
14	Reflector, Upper Element	---	---	04.05.615.00
15	Wire Feed Ramp	---	---	04.05.640.00
16A	Speed Control, Rheostat	---	---	---
16B/C	Speed Control, Rheostat	---	---	02.13.338.00
17A	Indicator Light, Green	---	---	---
	Indicator Light, Red (not shown)	---	---	---
17B/C	Indicator Light, Green	---	---	02.19.150.00
	Indicator Light, Red (not shown)	---	---	---
18	Crumb Tray	---	---	R04.05.625.00
19A	Decal, Control	---	---	---
19B/C	Decal, Control	---	---	07.01.326.00
20A	Fan, Circulating	---	---	---
20B/C	Fan, Circulating	---	---	02.12.039.00
21	Fan Guard	---	---	---
22A	Cover, Cooling Fan	---	---	---
22B/C	Cover, Cooling Fan	---	---	---
23	Discharge Chute	---	---	04.05.628.00
24	Shaft Assembly (Qty. 2)	---	---	04.05.386.00
25A	Rear Discharge Tray	---	---	---
25B/C	Rear Discharge Tray	---	---	04.05.629.00
26A	Discharge Vane	---	---	---
26B/C	Discharge Vane	---	---	04.05.627.00
27	Wire Belt	---	---	05.03.036.00
28	Sprocket, Conveyor	---	---	05.09.055.00
29	Drive Chain	---	---	05.03.049.00
30	Sprocket, Motor *	---	---	05.09.056.00
31	Gear Motor	---	---	02.12.096.00
32A/B	Heating Element, Upper, 1000 W	---	---	---
	Heating Element, Upper, 1000 W	---	---	---
32C	Heating Element, Upper/Lower, 1130 W (Qty. 2)	---	---	02.05.761.00
33A/B	Heating Element, Lower, 750 W	---	---	---
	Heating Element, Lower, 900 W	---	---	---
34A	Reflector, Lower Element	---	---	---
34B/C	Reflector, Lower Element	---	---	---
35	Power Cord—NEMA 5-15 Plug	---	---	---
	Power Cord—No Plug	---	---	02.18.038.00
	Power Cord—BS 1363 Plug*	---	---	02.18.068.00
	Power Cord—Schuko Plug	---	---	02.18.038.00
	Wiring Diagram	---	---	10-01-356

‡ Toasters with a manufacturing date code of 1136 and newer (“C” numbers) use one of Item 12B for the bottom element along with one of Item 12C for the top element.

\* Units equipped with the BS 1363 plug set use Motor Sprocket P/N 05.09.057.00 (14 tooth).

## PARTS SPECIFIC TO MODEL TM-10H

Item	Description	100 V 50 Hz	120 V 60 Hz	220-240 V (CE) 50 Hz
12A	Bracket, Element (Qty. 2)	---	X04.05.449.00	X04.05.449.00
12B	Bracket, Element (Qty. 2)	---	04.05.575.00	04.05.575.00
12C	Bracket, Element, Top ‡	---	04.05.750.00	04.05.750.00
13A	Top Cover w/Insulation	---	X04.05.434.00	X04.05.434.00
13B/C	Top Cover w/Insulation	---	R04.05.619.00	R04.05.619.00
14	Reflector, Upper Element	---	04.05.615.00	04.05.615.00
15	Wire Feed Ramp	---	04.05.640.00	04.05.640.00
16A	Speed Control, Rheostat	---	X02.13.331.00	X02.13.330.00
16B/C	Speed Control, Rheostat	---	02.13.339.00	02.13.338.00
17A	Indicator Light, Green	---	X02.19.185.00	X02.19.175.00
	Indicator Light, Red (not shown)	---	X02.19.184.00	X02.19.176.00
17B/C	Indicator Light, Green	---	---	02.19.150.00
	Indicator Light, Red (not shown)	---	02.19.154.00	---
18	Crumb Tray	---	R04.05.625.00	R04.05.625.00
19A	Decal, Control	---	X07.03.466.00	X07.03.466.00
19B/C	Decal, Control	---	07.01.326.00	07.01.326.00
20A	Fan, Circulating	---	X02.12.085.00	X02.12.082.00
20B/C	Fan, Circulating	---	02.12.030.00	02.12.039.00
21	Fan Guard	---	---	---
22A	Cover, Cooling Fan	---	X04.05.446.00	X04.05.446.00
22B/C	Cover, Cooling Fan	---	---	---
23	Discharge Chute	---	04.05.628.00	04.05.628.00
24	Shaft Assembly (Qty. 2)	---	04.05.386.00	04.05.386.00
25A	Rear Discharge Tray	---	X04.05.438.00	X04.05.438.00
25B/C	Rear Discharge Tray	---	04.05.629.00	04.05.629.00
26A	Discharge Vane	---	X04.05.441.00	X04.05.441.00
26B/C	Discharge Vane	---	04.05.627.00	04.05.627.00
27	Wire Belt	---	05.03.036.00	05.03.036.00
28	Sprocket, Conveyor	---	05.09.055.00	05.09.055.00
29	Drive Chain †	---	05.03.049.00	05.03.049.00
30	Sprocket, Motor *	---	05.09.056.00	05.09.056.00
31	Gear Motor	---	02.12.081.00	02.12.096.00
32A/B	Heating Element, Upper, 1000 W	---	02.05.675.00	---
	Heating Element, Upper, 1000 W	---	---	02.05.642.00
32C	Heating Element, Upper, 1100 W	---	---	02.05.765.00
33A/B	Heating Element, Lower, 750 W	---	02.05.676.00	---
	Heating Element, Lower, 900 W	---	---	02.05.674.00
33C	Heating Element, Lower, 800 W	---	---	02.05.766.00
34A	Reflector, Lower Element	---	X04.05.528.00	X04.05.528.00
34B/C	Reflector, Lower Element	---	---	---
35	Power Cord—NEMA 5-15 Plug	---	R02.18.154.00	---
	Power Cord—No Plug	---	---	02.18.038.00
	Power Cord—BS 1363 Plug*	---	---	02.18.068.00
	Power Cord—Schuko Plug	---	---	02.18.038.00
	Wiring Diagram	---	10-01-356	10-01-356

‡ Toasters with a manufacturing date code of 1136 and newer ("C" numbers) use only one of Item 12B for the bottom element along with one of Item 12C for the top element.

† Drive Chain P/N 05.03.044.00 is used on TM-10H models manufactured before year 2005, week thirty-eight.

\* Units equipped with the BS 1363 plug set use Motor Sprocket P/N 05.09.057.00 (14 tooth).



---



HATCO CORPORATION  
P.O. Box 340500  
Milwaukee, WI 53234-0500 U.S.A.  
Telephone (414) 671-6350  
International Fax (414) 671-3976  
partsandservice@hatcocorp.com  
www.hatcocorp.com



HATCO CORPORATION  
ASIA HEADQUARTERS  
Unit 101, Premier Center, 20 Cheung Shun Street  
Cheung Sha Wan, Kowloon, H.K.  
Telephone (852) 2991-4121  
Fax (852) 2991-4181  
hongkong@hatcocorp.com